

GAS BALL VALVES

Submittal Information

Part No 12426-12428
 Document No. SPEC12426
 Date 2021-02-22
 Revision 02

General Properties

Material: Copper-alloy casting
 Handle: Aluminum
 Temperatures range: -4 to 194 F
 Max. Pressure: 600 PSI WOG

Applications

- CSA approved manually operated gas valve for use in house piping system, appliances, appliance connector valves and hose end valves.
- Designed for use in air, water, oil, nature, manufactured, mixed, liquefied petroleum or propane.

Technology Requirements

1. The parts should be cleaned before assembly, and no impurities should be brought into the valve body.
2. The turning handle should be flexible and free from jamming.
3. After 0.6Mpa air tightness test, keep the pressure for 15 seconds without leakage.
4. The nominal pressure is 0.15Mpa.
5. When the valve is fully open, the angle between the ball through hole axis and the valve body through hole axis is not more than 3°.

Features

- Brass body with NPT threads.
- Durable, long-term use and excellent performance, tested to be 100% leak-proof.
- Easy to use and easy to install.
- UL listed for safe use with LP gas, natural gas and heated oils.
- Ideal for indoor and outdoor use.

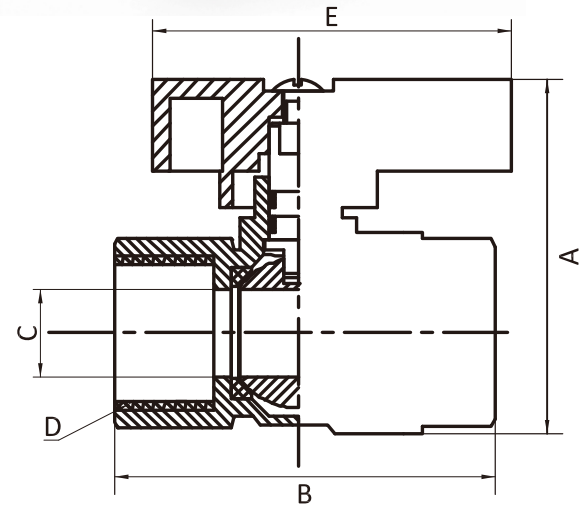
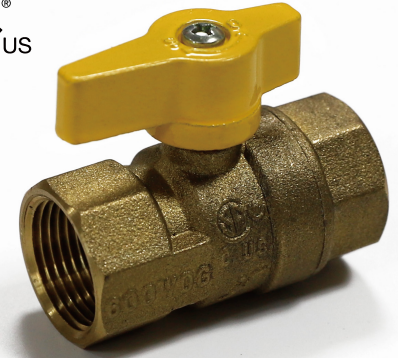

ITEM NO.	Specifications	DETAIL(INCH)				
		A	B	C	D	E
12426	1/2" FIP x 1/2" FIP	1.80	2.17	0.44	1/2" NPT	1.90
12427	3/4" FIP X 3/4" FIP	2.15	2.43	0.60	3/4" NPT	1.90
12428	1" FIP x 1" FIP	3.00	3.10	0.97	1.0" NPT	2.50

C: Minimum diameter of gas pathway through valve.